

Straight handle
back to back
1" diameter "std"

Dim "A"—10-12 "custom size available"

* FINISHES AVAILABLE :
8 POLISHED & # 4 SATIN
STAINLESS
US3 POLISHED & US4 SATIN
BRASS (NON LACQUER COATED)
US10B
ANODIZED PAINTED

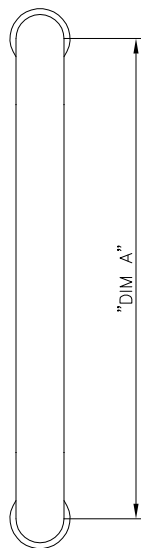
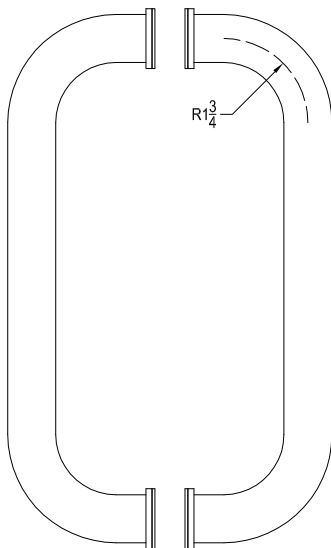
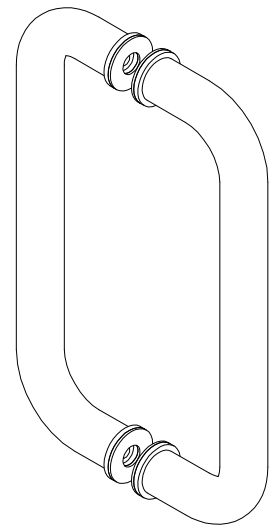
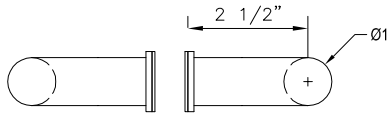

Offset handle
back to back
1" diameter "std"

Dim "A"—10-12 "custom size available upon request"

* FINISHES AVAILABLE :
8 POLISHED & # 4 SATIN
STAINLESS
US3 POLISHED & US4 SATIN
BRASS (NON LACQUER COATED)
US10B
ANODIZED PAINTED

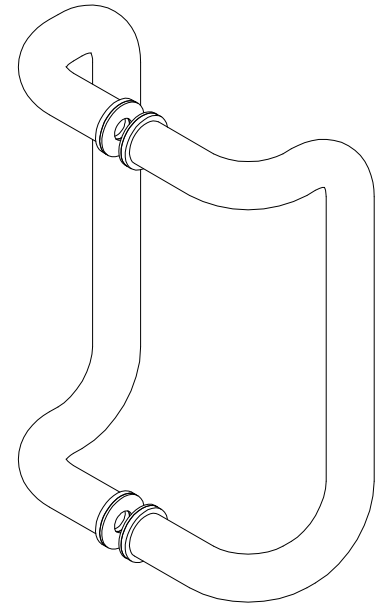
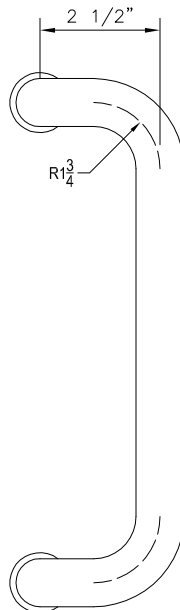
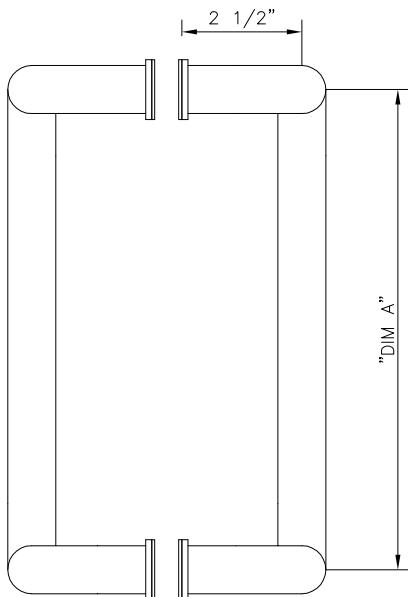
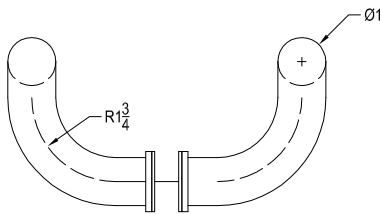

* FINISHES AVAILABLE :
8 POLISHED & # 4 SATIN
STAINLESS
POLISHED BRASS

Curved handle
back to back
1" diameter "std"

Dim "A"—12" "Only"

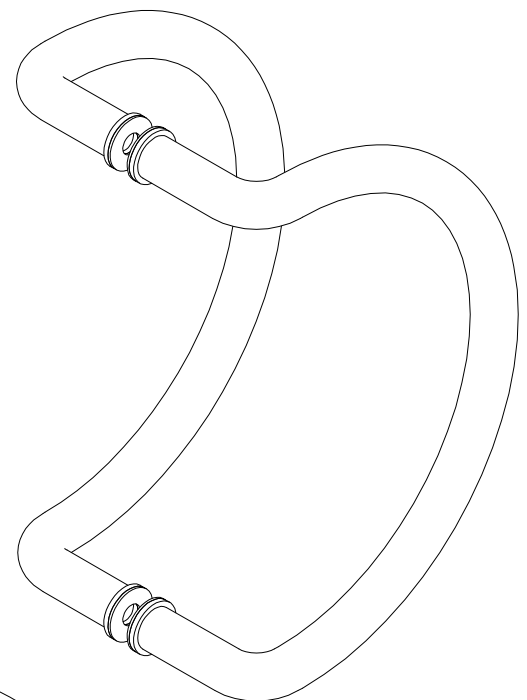
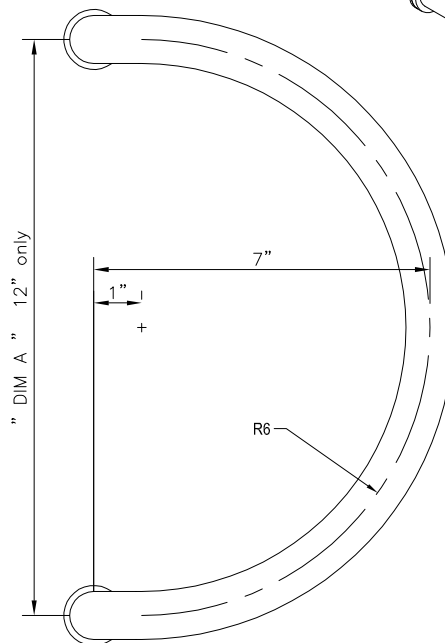
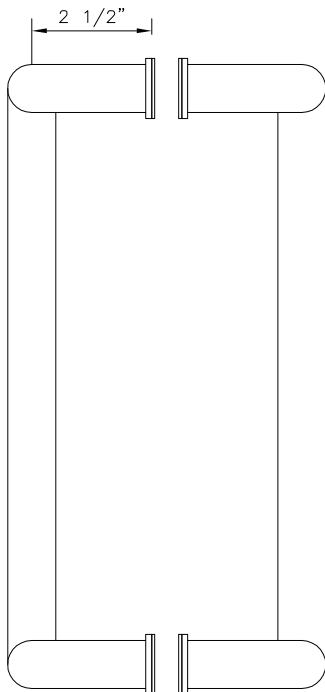
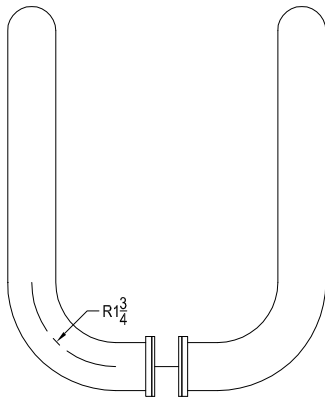

Push pull handle set
straight exterior
back to back
1" diameter "std"

*** FINISHES AVAILABLE :**
8 POLISHED & # 4 SATIN
STAINLESS
US3 POLISHED & US4 SATIN
BRASS (NON LACQUER COATED)
US10B
ANODIZED PAINTED

Dim " A "—10-12 "custom size available upon request"
Dim " B "—28 "custom size available upon request"

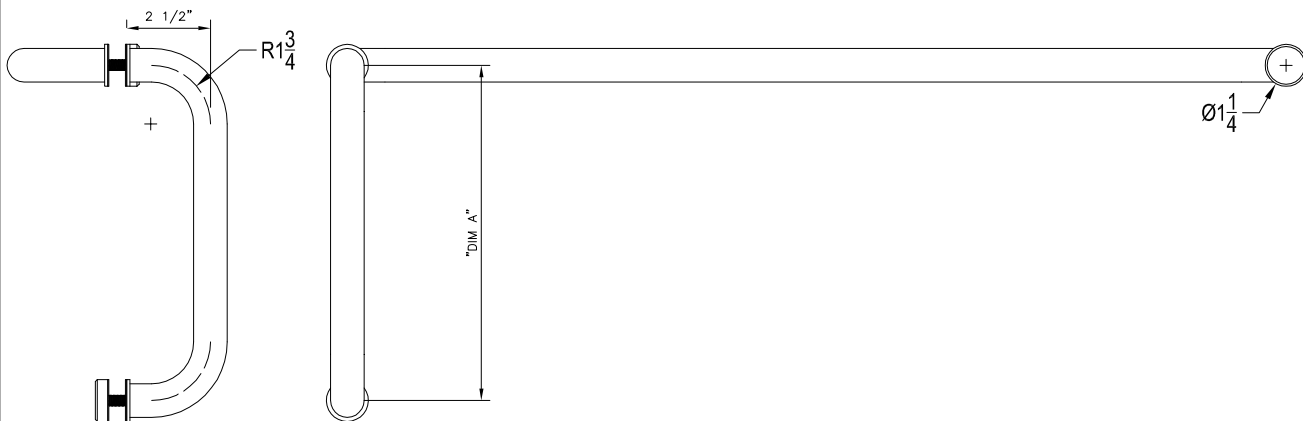
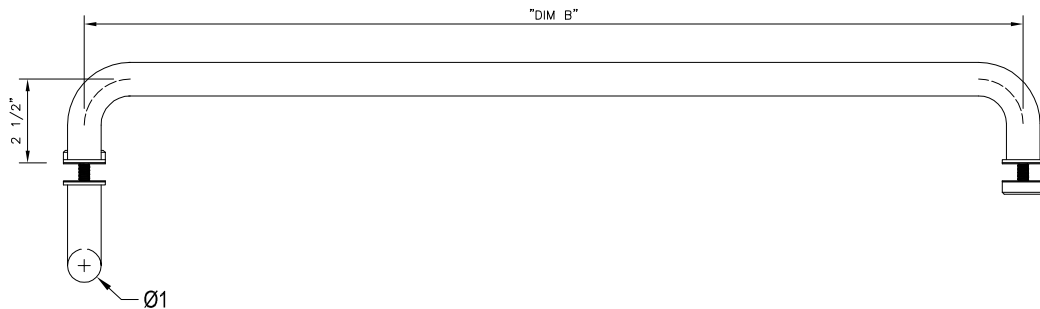
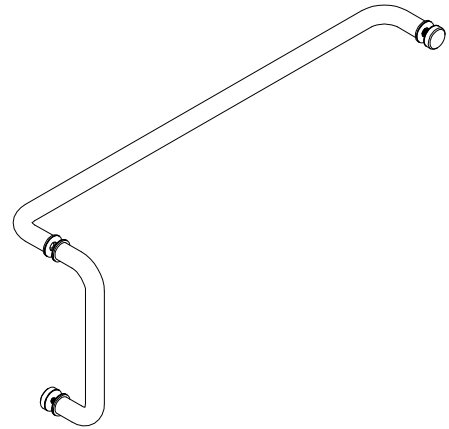

Push pull handle set
offset exterior
back to back
1" diameter "std"

*** FINISHES AVAILABLE :**
8 POLISHED & # 4 SATIN
STAINLESS
US3 POLISHED & US4 SATIN
BRASS (NON LACQUER COATED)
US10B
ANODIZED PAINTED

Dim " A "—10-12 "custom size available upon request"
Dim " B "—28 "custom size available upon request"

